

# standard steam rooms

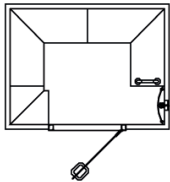

**Standard Model 1 Steam Room**  
 Size: O.D. 2120mm x 1635mm  
 (I.D. 2000mm x 1500mm)  
 Height: 2260mm  
 4 - 6 Person seating capacity.  
 6.0kW - 1 or 3 Phase

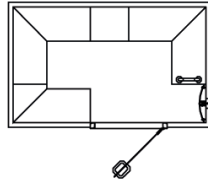

**Standard Model 2 Steam Room**  
 Size: O.D. 2620mm x 1635mm  
 (I.D. 2500mm x 1500mm)  
 Height: 2310mm  
 6 - 8 Person seating capacity.  
 6.0kW - 1 or 3 Phase

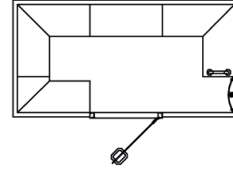

**Standard Model 3 Steam Room**  
 Size: O.D. 3120mm x 1635mm  
 (I.D. 3000mm x 1500mm)  
 Height: 2360mm  
 8 - 10 Person seating capacity.  
 6.0kW - 1 or 3 Phase

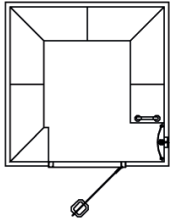

**Standard Model 4 Steam Room**  
 Size: O.D. 2120mm x 2135mm  
 (I.D. 2000mm x 2000mm)  
 Height: 2260mm  
 6 - 8 Person seating capacity.  
 6.0kW - 1 or 3 Phase

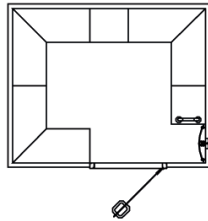

**Standard Model 5 Steam Room**  
 Size: O.D. 2620mm x 2135mm  
 (I.D. 2500mm x 2000mm)  
 Height: 2310mm  
 8 - 10 Person seating capacity.  
 6.0kW - 1 or 3 Phase

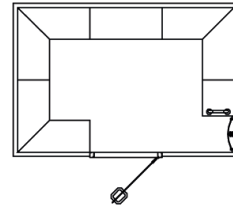

**Standard Model 6 Steam Room**  
 Size: O.D. 3120mm x 2135mm  
 (I.D. 3000mm x 2000mm)  
 Height: 2360mm  
 10 - 12 Person seating capacity.  
 11.4kW - 3 Phase

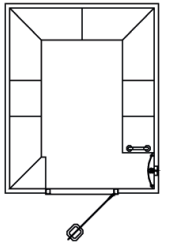

**Standard Model 7 Steam Room**  
 Size: O.D. 2120mm x 2635mm  
 (I.D. 2000mm x 2500mm)  
 Height: 2260mm  
 6 - 10 Person seating capacity.  
 11.4kW - 3 Phase

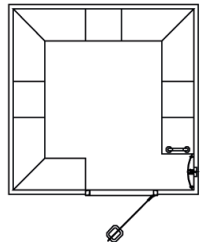

**Standard Model 8 Steam Room**  
 Size: O.D. 2620mm x 2635mm  
 (I.D. 2500mm x 2500mm)  
 Height: 2310mm  
 10 - 12 Person seating capacity.  
 11.4kW - 3 Phase

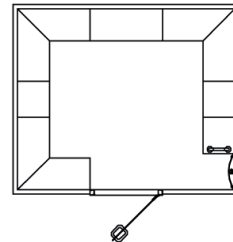

**Standard Model 9 Steam Room**  
 Size: O.D. 3120mm x 2635mm  
 (I.D. 3000mm x 2500mm)  
 Height: 2610mm  
 12 - 14 Person seating capacity.  
 11.4kW - 1 or 3 Phase

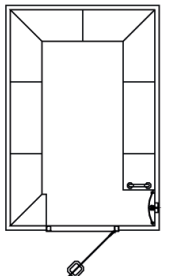

**Standard Model 10 Steam Room**  
 Size: O.D. 2120mm x 3135mm  
 (I.D. 2000mm x 3000mm)  
 Height: 2260mm  
 10 - 12 Person seating capacity.  
 11.4kW - 3 Phase

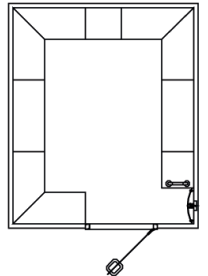

**Standard Model 11 Steam Room**  
 Size: O.D. 2620mm x 3135mm  
 (I.D. 2500mm x 3000mm)  
 Height: 2310mm  
 12 - 14 Person seating capacity.  
 11.4kW - 3 Phase

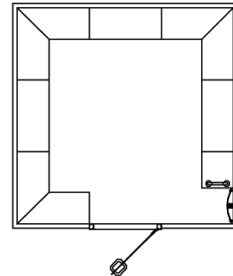

**Standard Model 12 Steam Room**  
 Size: O.D. 3120mm x 3135mm  
 (I.D. 3000mm x 3000mm)  
 Height: 2360mm  
 14 - 16 Person seating capacity.  
 11.4kW - 3 Phase

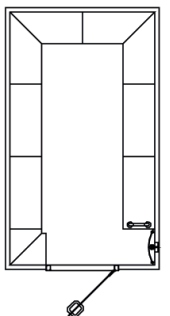

**Standard Model 13 Steam Room**  
 Size: O.D. 2120mm x 3635mm  
 (I.D. 2000mm x 3500mm)  
 Height: 2260mm  
 14 - 16 Person seating capacity.  
 11.4kW - 1 or 3 Phase

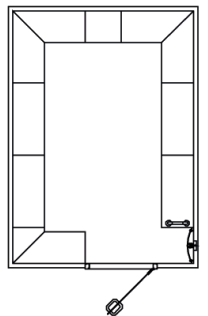

**Standard Model 14 Steam Room**  
 Size: O.D. 2620mm x 3635mm  
 (I.D. 2500mm x 3500mm)  
 Height: 2310mm  
 16 - 18 Person seating capacity.  
 11.4kW - 3 Phase

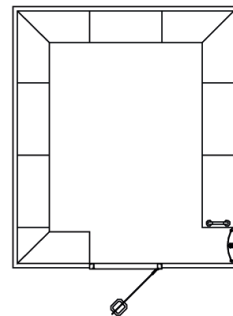

**Standard Model 15 Steam Room**  
 Size: O.D. 3120mm x 3620mm  
 (I.D. 3000mm x 3500mm)  
 Height: 2360mm  
 18 - 20 Person seating capacity.  
 11.4kW - 3 Phase

# standard steam rooms

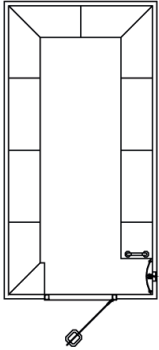

**Standard Model 16 Steam Room**  
Size: O.D. 2120mm x 4135mm  
(I.D. 2000mm x 4000mm)  
Height: 2260mm  
14 - 16 Person seating capacity.  
11.4kW - 3 Phase

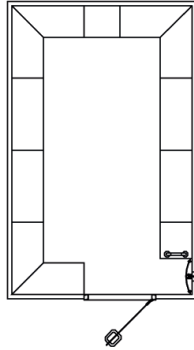

**Standard Model 17 Steam Room**  
Size: O.D. 2620mm x 4135mm  
(I.D. 2500mm x 4000mm)  
Height: 2310mm  
18 - 20 Person seating capacity.  
11.4kW - 1 or 3 Phase

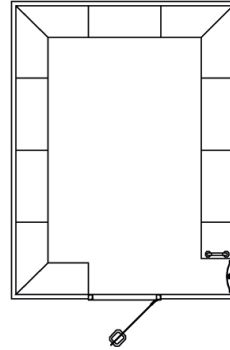

**Standard Model 18 Steam Room**  
Size: O.D. 3120mm x 4135mm  
(I.D. 3000mm x 4000mm)  
Height: 2360mm  
20 - 22 Person seating capacity.  
22.8kW - 3 Phase

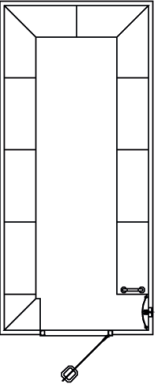

**Standard Model 19 Steam Room**  
Size: O.D. 2120mm x 4635mm  
(I.D. 2000mm x 4500mm)  
Height: 2360mm  
16 - 18 Person seating capacity.  
11.4kW - 3 Phase

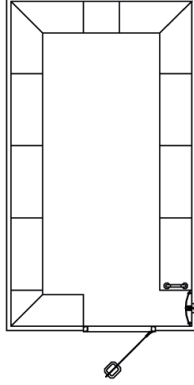

**Standard Model 20 Steam Room**  
Size: O.D. 2620mm x 4635mm  
(I.D. 2500mm x 4500mm)  
Height: 2310mm  
18 - 20 Person seating capacity.  
11.4kW - 3 Phase

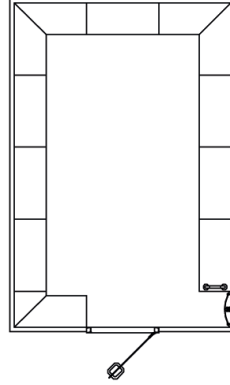

**Standard Model 21 Steam Room**  
Size: O.D. 3120mm x 4635mm  
(I.D. 3000mm x 4500mm)  
Height: 2360mm  
22 - 24 Person seating capacity.  
22.8kW - 1 or 3 Phase

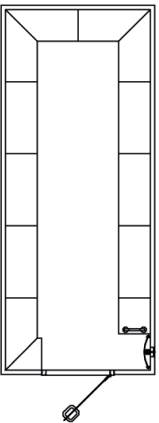

**Standard Model 22 Steam Room**  
Size: O.D. 2120mm x 5135mm  
(I.D. 2000mm x 5000mm)  
Height: 2260mm  
18 - 20 Person seating capacity.  
22.8kW - 3 Phase

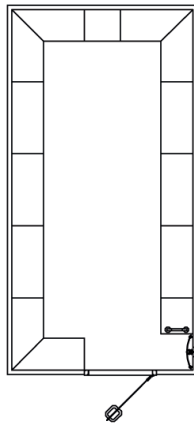

**Standard Model 23 Steam Room**  
Size: O.D. 2620mm x 5135mm  
(I.D. 2500mm x 5000mm)  
Height: 2310mm  
20 - 22 Person seating capacity.  
22.8kW - 3 Phase

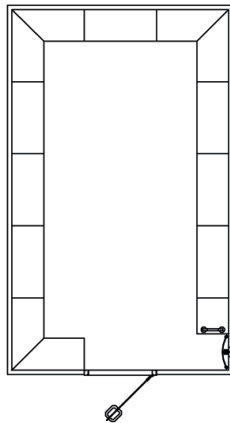

**Standard Model 24 Steam Room**  
Size: O.D. 3120mm x 5135mm  
(I.D. 3000mm x 5000mm)  
Height: 2360mm  
24 - 26 Person seating capacity.  
22.8kW - 3 Phase